



# ***FFP BOW MOUNT ANCHOR NESTS***



208-580-1904  
[www.fishfighterproducts.com](http://www.fishfighterproducts.com)



# ***FISH FIGHTER***<sup>™</sup> *Products*

***RELENTLESSLY IN THE PURSUIT OF BIG FISH***

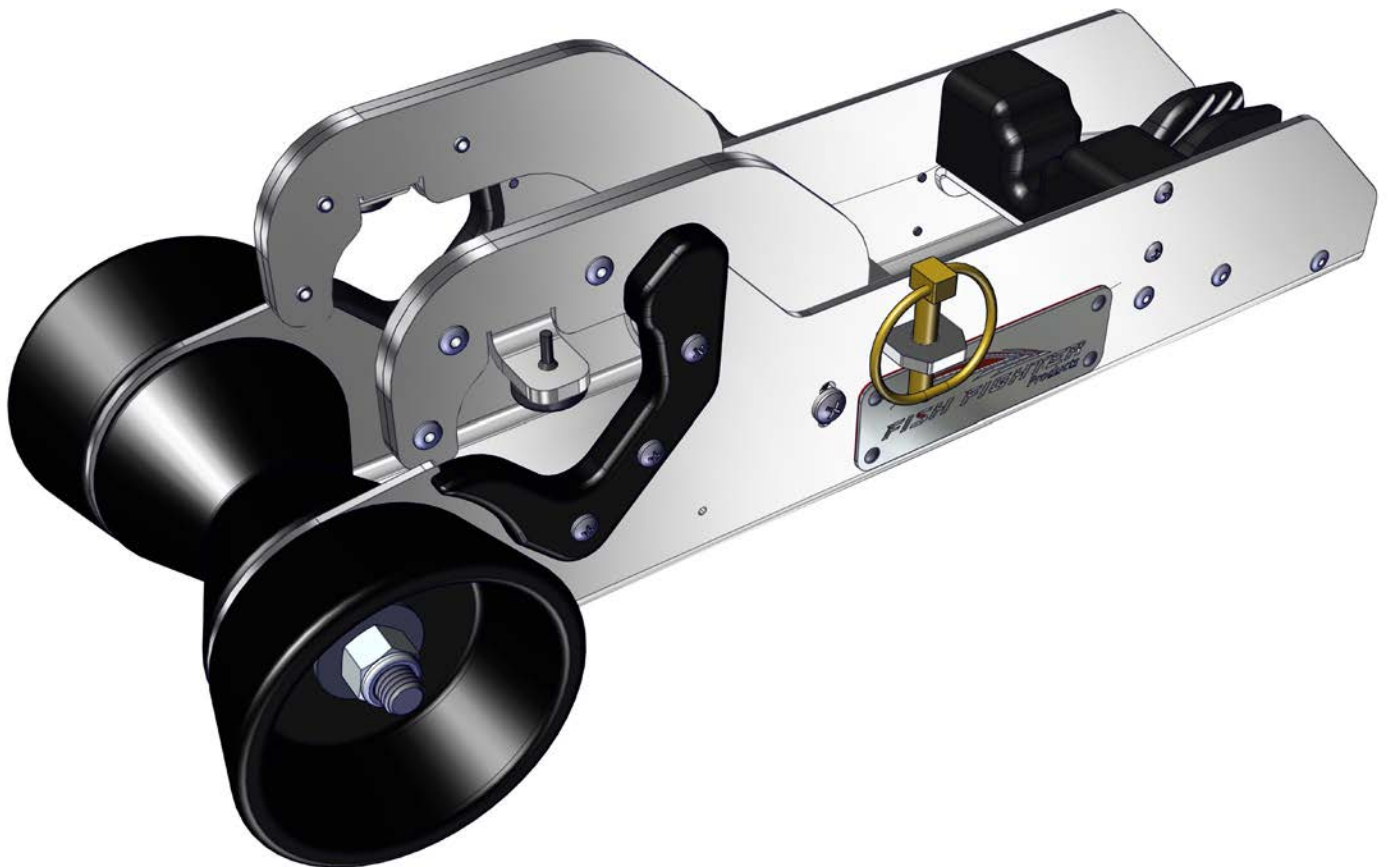

## ***TABLE OF CONTENTS***

<b>Bow Mount Anchor Nests .....</b>	<b>Pgs. 1</b>
<b>Bow Mount Anchor Nests Comparison .....</b>	<b>Pgs. 2</b>
<b>Adjusting the Nests to Fit your Anchor .....</b>	<b>Pgs. 2</b>
<b>ITD5090 Dimensions .....</b>	<b>Pgs. 3</b>
<b>ITD5690 Dimensions .....</b>	<b>Pgs. 4</b>
<b>Replacement Parts .....</b>	<b>Pgs. 5</b>
<b>Loading Anchor .....</b>	<b>Pgs. 6-7</b>
<b>Rope Cleat .....</b>	<b>Pgs. 8</b>

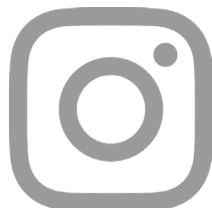

## ***BOW MOUNT ANCHOR NESTS***

PART #	DESCRIPTION
ITD5090	<b>Bow Mount Anchor Nest For 26,32, And 40 lb Breakaway River Anchors</b>
ITD5690	<b>Extreme Duty Bow Mount Anchor Nest For 26,32, And 40 lb Breakaway River Anchors</b>

### **ITD5090 - Bow Mount Anchor Nest**



### **ITD5690 - Extreme Duty Bow Mount Anchor Nest**



## Bow Mount Anchor Nests Comparison

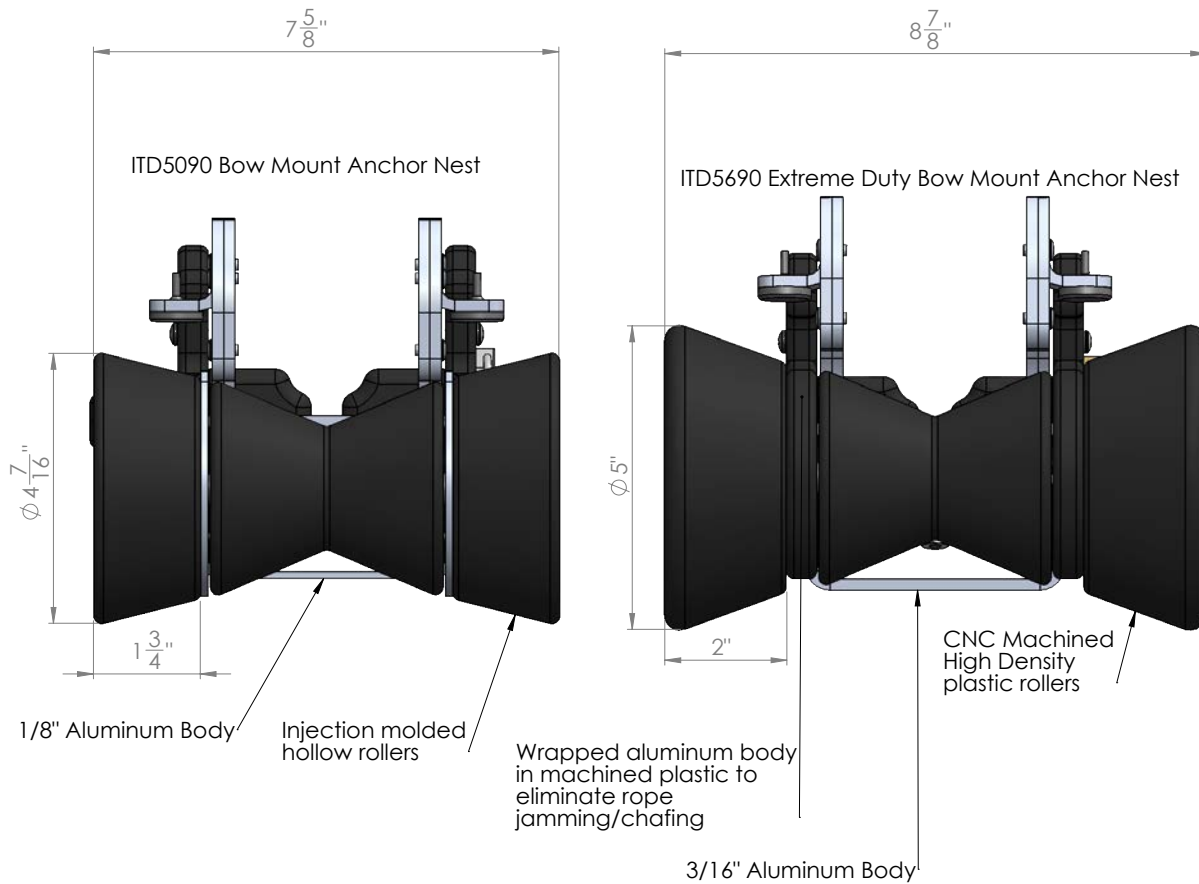

## Adjusting The Nest To Fit Your Anchor

To adjust the anchor nest to fit your anchor, simply remove the 2 pivot bolts and set the anchor latch at the appropriate height setting

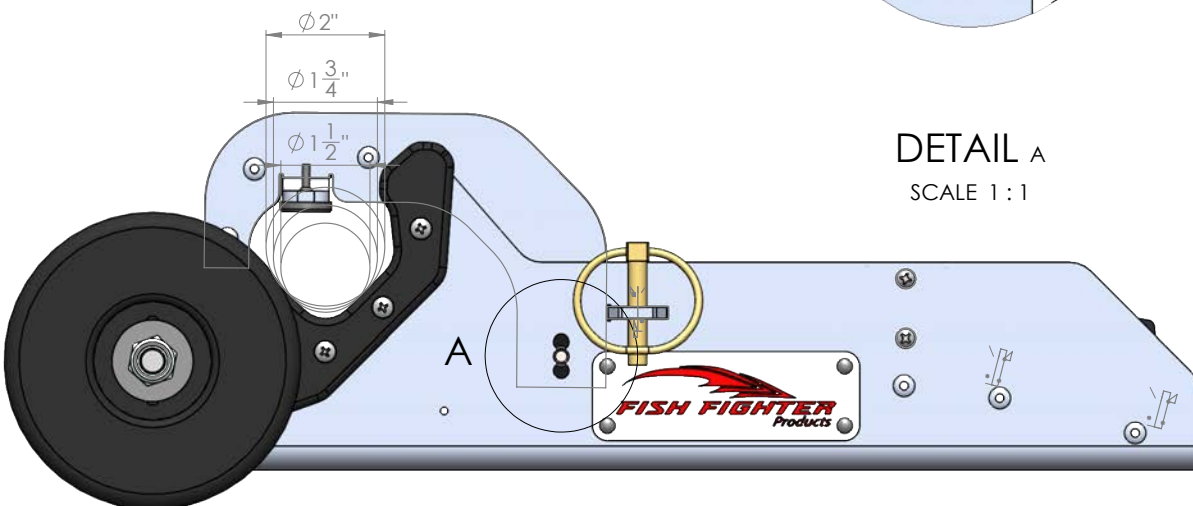
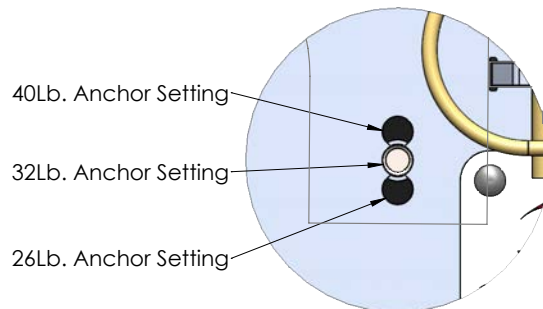

## ITD5090 - Bow Mount Anchor Nest Dimensions

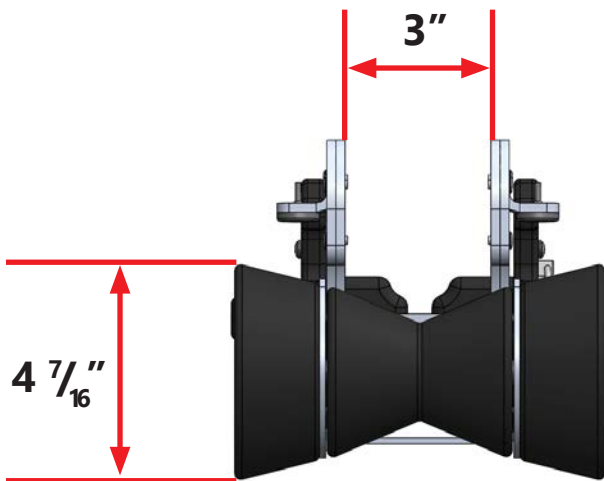
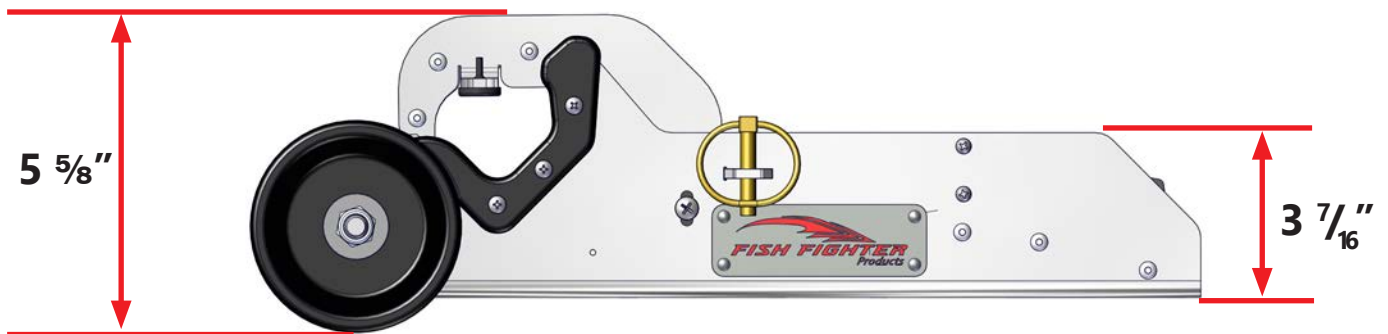
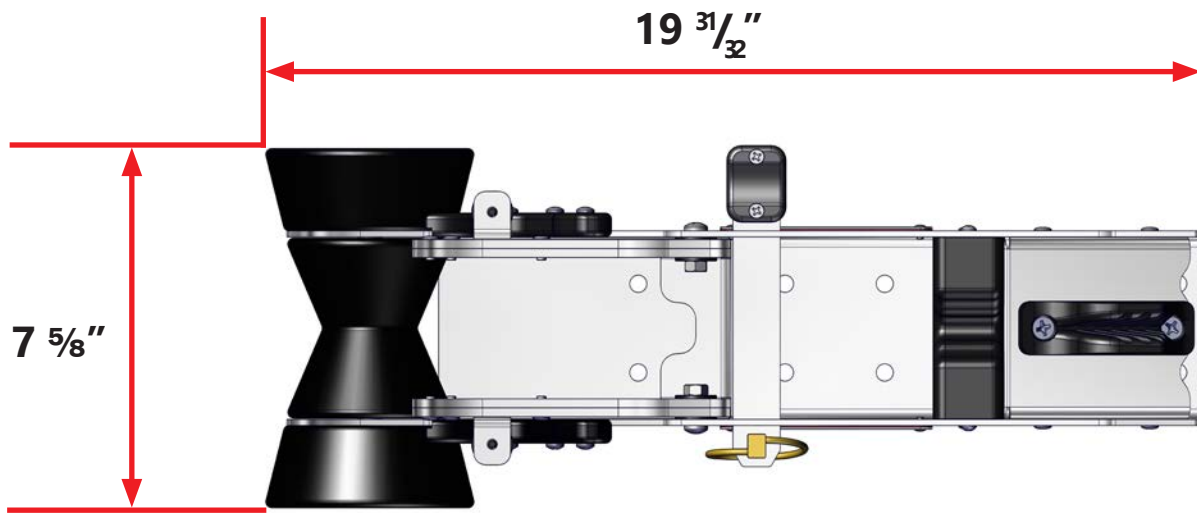

### ***WARNING***



It is up to the installer to ensure that the Deck Mount Anchor Nest is properly installed. Test fit anchor in the nest on the boat to check anchor clearance from the bow



## ITD5690 - Extreme Duty Bow Mount Anchor Nest Dimensions

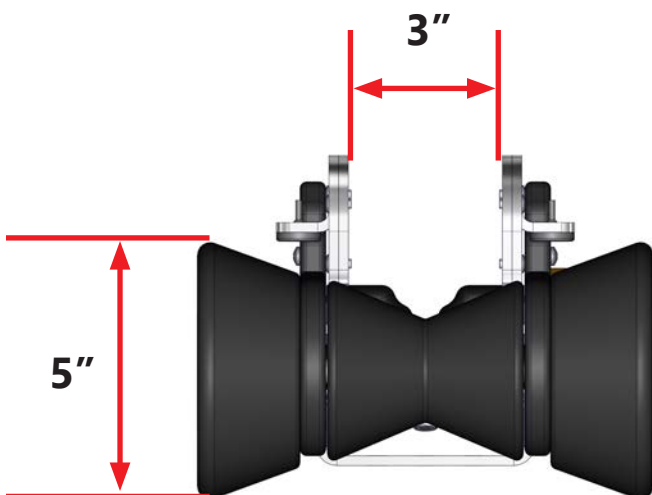
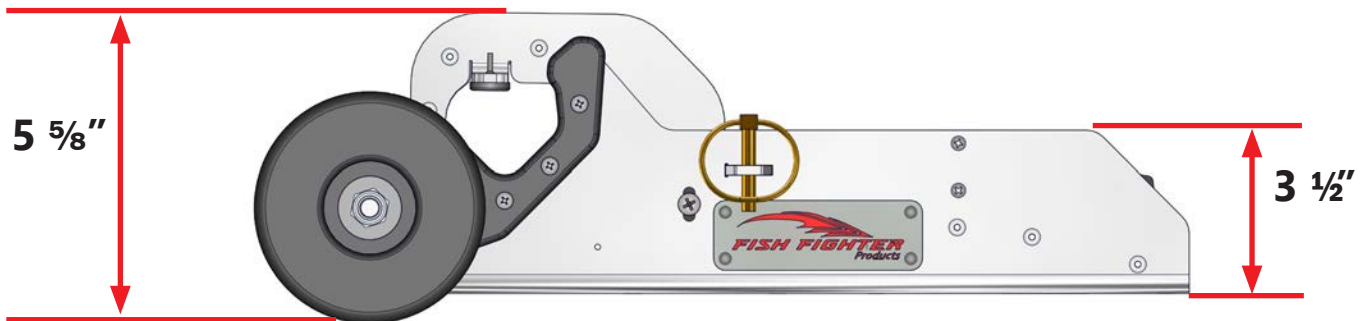
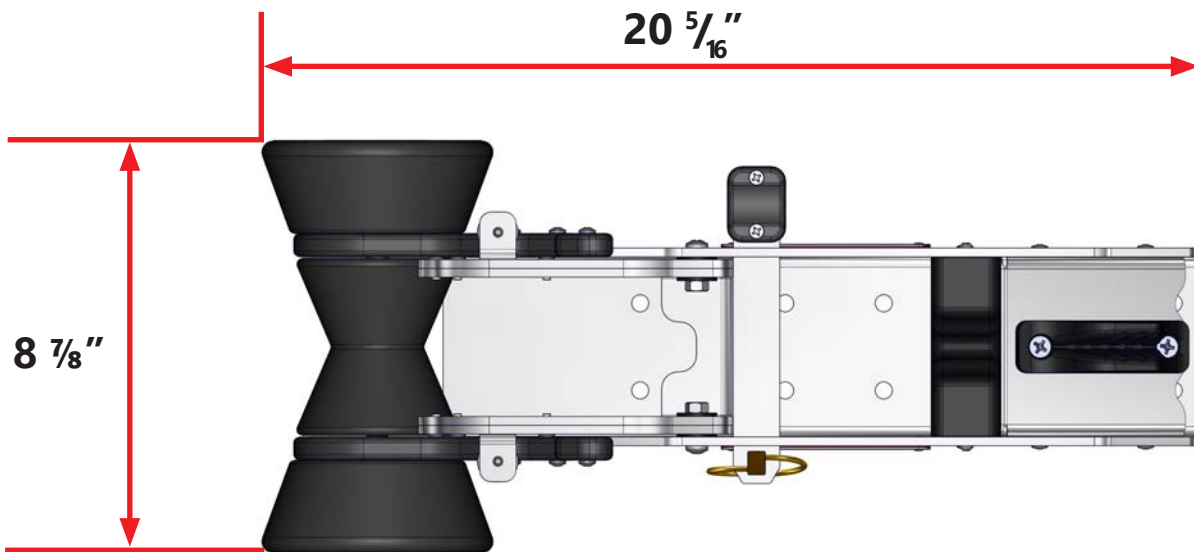

### ***WARNING***



It is up to the installer to ensure that the Deck Mount Anchor Nest is properly installed. Test fit anchor in the nest on the boat to check anchor clearance from the bow

## Replacement Parts

### Hardware Included

- (4) - 5/16" Nylon Washer
- (2) - 1/4" 20 X 1 SS Cap Screw
- (2) - 1/4"-20 SS Nylock

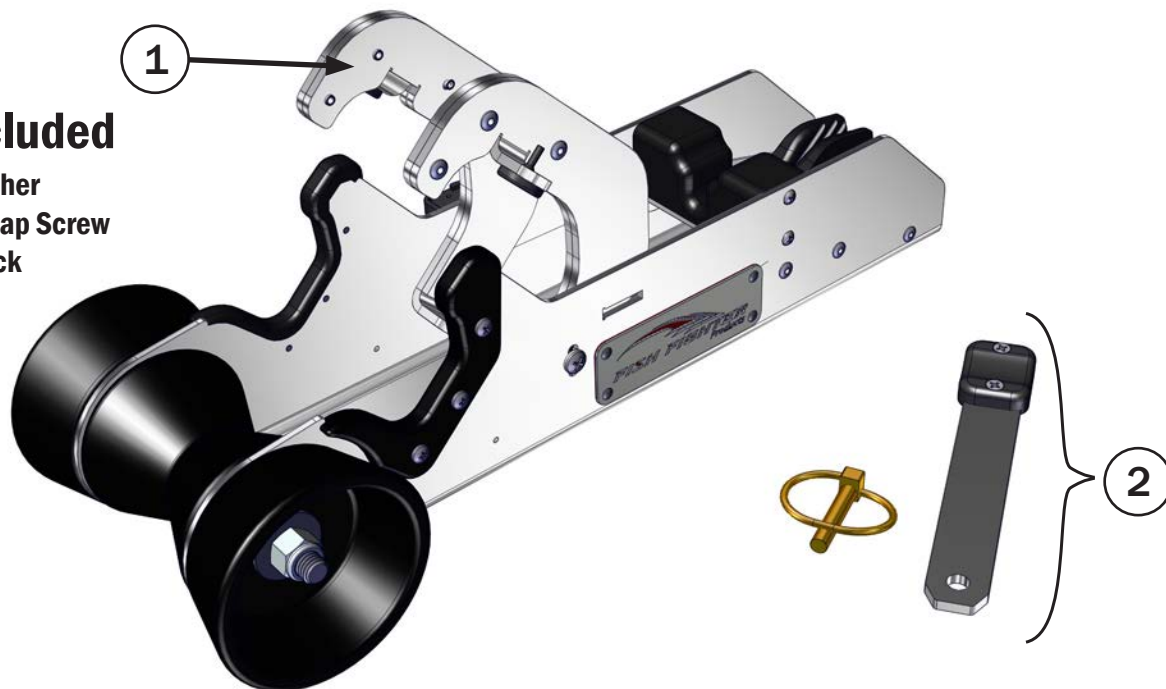

Bow Mount Anchor Nests		
Item #	Part #	Description
1	ITD5573	Anchor Latch with Rubber Bumpers (Includes Mounting Hardware, fits both styles of anchor nests)
2	ITD5574	Lock Bar with Handle, Lynch clip, and Lanyard

### Installing Replacement Lanyard

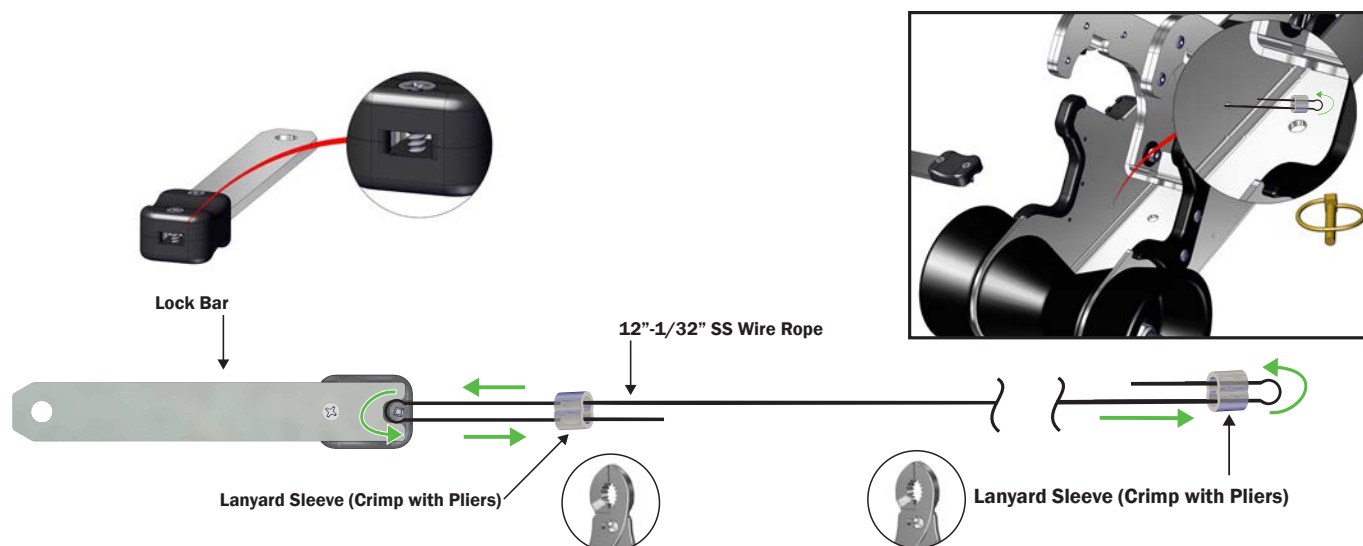



## Loading Anchor

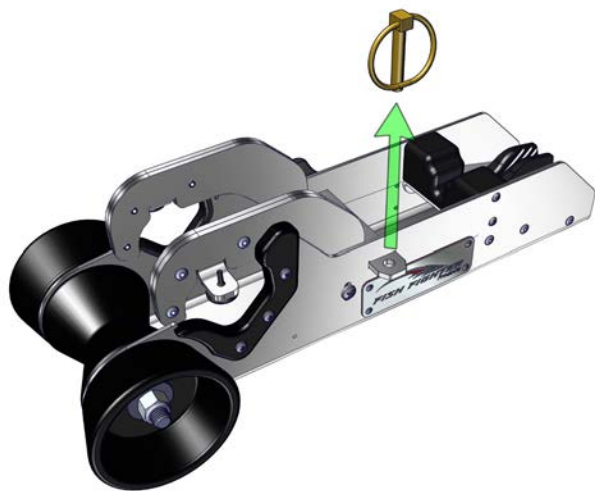

Pull Lynch pin from Lock Bar

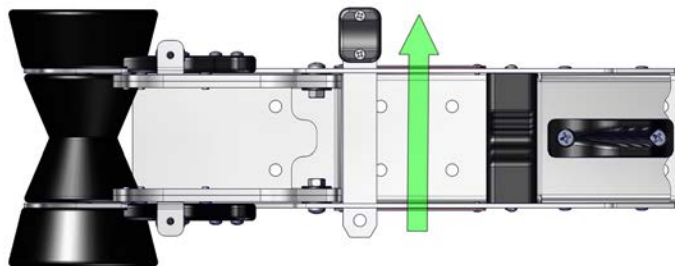

Pull Lock Bar from Anchor nest



Open Anchor Latch



Retrieve Anchor with the chain facing up



Once the Anchor has been retrieved and put into the nest, close the anchor latch

### ***WARNING***



Observe any and all local and state regulations regarding operating watercraft



Do not anchor in swift currents except in emergency situations.

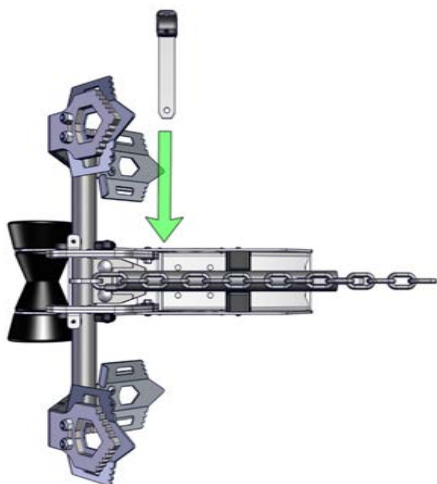

Replace Lock bar

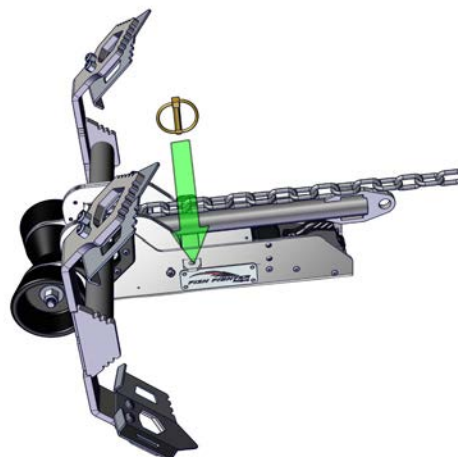

Replace Lynch Pin to lock anchor in place

## ***WARNING***

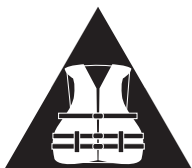

It is highly recommended that all passengers wear a life persevering safety jacket while aboard any operating water vessel.

## ***TECH TIP***

Install an extra zip tie to the top of the anchor to help from anchor from binding on anchor nest while retrieving the anchor

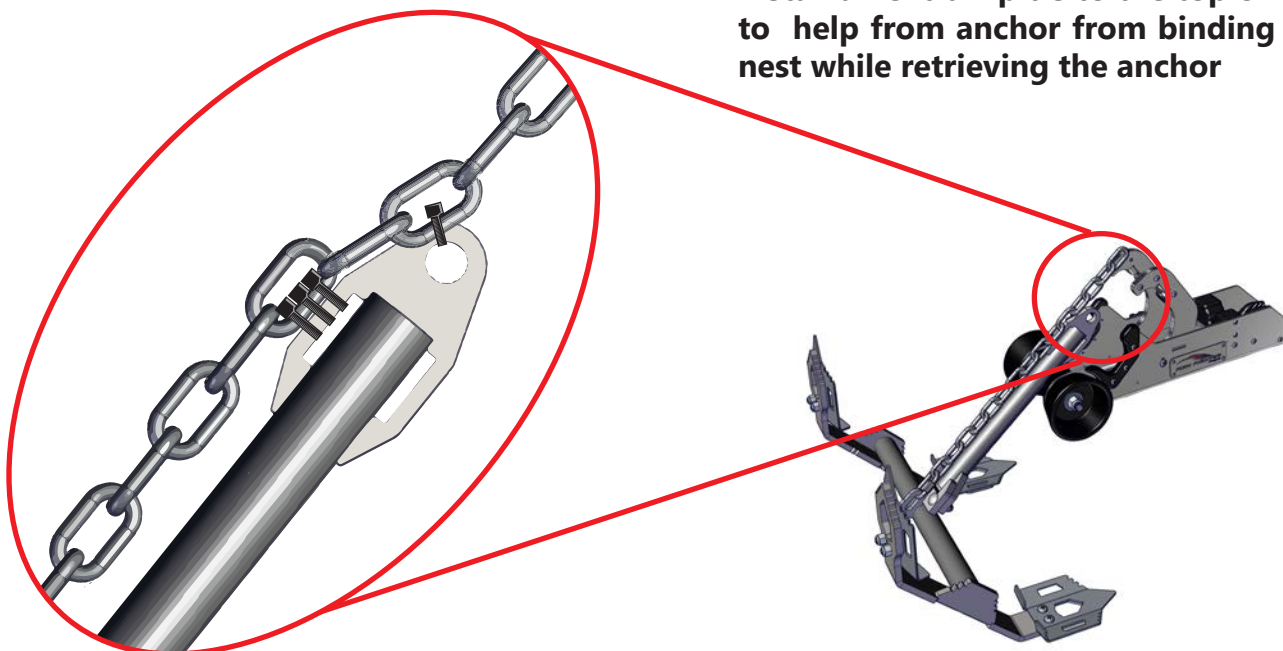

## Rope Cleat

The Bow Mount Anchor Nests have been designed with a built in rope cleat. This rope cleat will fit rope from 3/8" to 1/2".

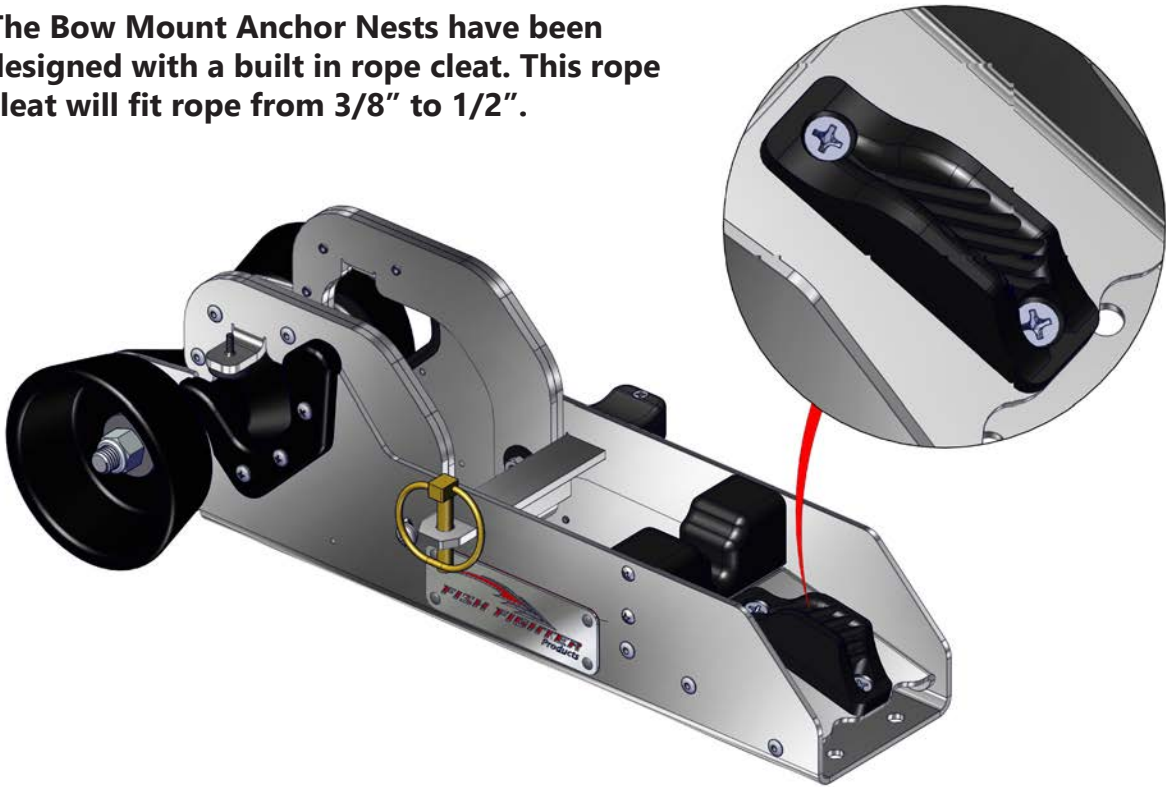

The rope cleat has a 1,000 lb working load limit

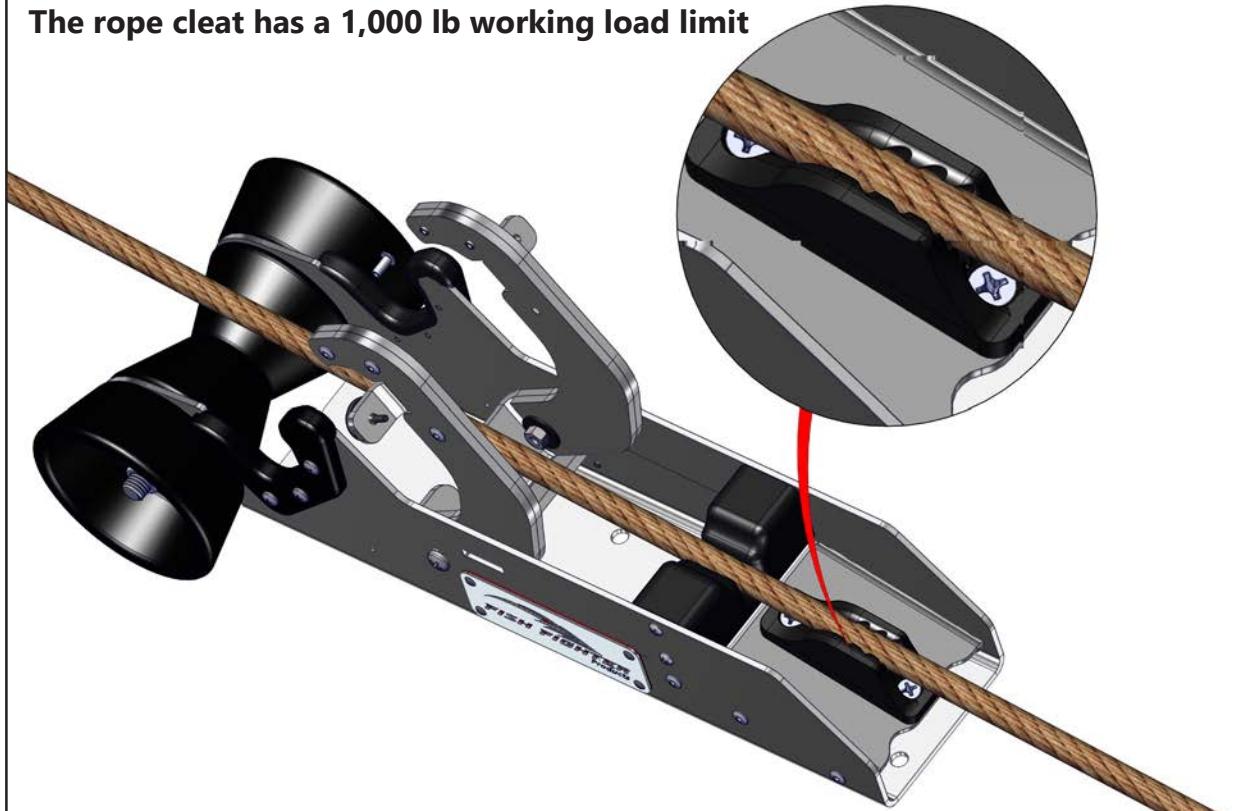



***FFP BOW MOUNT  
ANCHOR NESTS***

**For full warranty information visit  
[www.fishfighterproducts.com](http://www.fishfighterproducts.com)**

**Fish Fighter<sup>TM</sup> Products Support  
8:00 am to 5:00 pm MST  
Monday through Friday  
1-208-580-1904  
[sales@fishfighterproducts.com](mailto:sales@fishfighterproducts.com)**